

Ventosa con fuelle de 4.5 etapas

Diámetro de ventosa: $\varnothing 15$, $\varnothing 20$, $\varnothing 30$, $\varnothing 40$, $\varnothing 46$

- Para adsorber piezas que se desplazan a gran velocidad
- Adaptable a diversas formas de piezas.
- Material de ventosa: Goma de silicona (Dureza de la goma: A40, A50, A60)

• Modelo de rosca

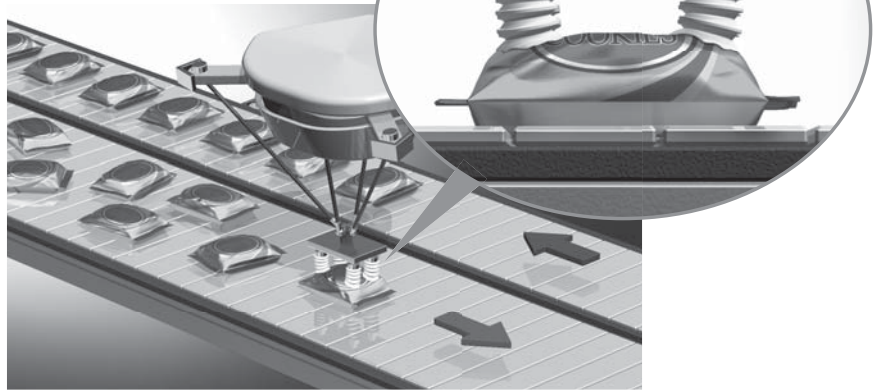
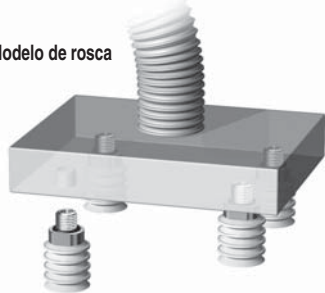

• Modelo de conexión instantánea

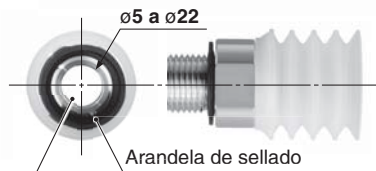
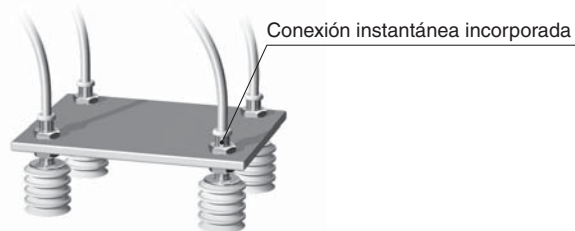

- Gran apertura (modelo de rosca corta): $\varnothing 5$ a $\varnothing 22$
Para bombas de de vacío con elevados caudales de succión

Forma de pedido

Entrada de vacío vertical con adaptador

ZP2-T B15 ZJ S-A10-06



Diámetro de ventosa •

Símbolo	Diámetro de ventosa
B15	$\varnothing 15$
B20	$\varnothing 20$
B30	$\varnothing 30$
40	$\varnothing 40$
46	$\varnothing 46$

• Entrada de vacío

Símbolo	Entrada de vacío	Tamaño de rosca de montaje					
		A10	A16	A20	A30	AL12	AL14
—	Rosca corta	●	●	●	●	—	—
06	Conexión instantánea ($\varnothing 6$)	—	—	—	—	●	●

Material de ventosa •

Símbolo	Material (color)	Dureza de la goma	Diámetro de ventosa aplicable				
			$\varnothing 15$	$\varnothing 20$	$\varnothing 30$	$\varnothing 40$	$\varnothing 46$
S	Goma de silicona (Blanco)	A40 (Nota)	●	●	●	—	—
		A50	—	—	—	●	●
S6	Goma de silicona (Modelo de elevada dureza (blanco))	A60	●	●	●	—	—

Nota) Identificación de la dureza de la goma: Pintado con 1 punto rosa

• Tamaño de rosca de montaje

Tipo	Símbolo	Tamaño de rosca (rosca macho)	$\varnothing 15$	$\varnothing 20$	$\varnothing 30$	$\varnothing 40$	$\varnothing 46$
Rosca corta	A10	M10 x 1	●	●	—	—	—
	A16	M16 x 1.5	—	—	●	—	—
	A20	M20 x 1.5	—	—	—	●	—
	A30	M30 x 1.5	—	—	—	—	●
Conexión instantánea	AL12	M12 x 1	●	●	—	—	—
	AL14	M14 x 1	—	—	●	●	●

Ref. de repuestos (Modelo de rosca corta)

Ref. producto	Ref. de unidad de ventosa	Ref. del adaptador
ZP2-TB15ZJS□-A10	ZP2-B15ZJS□	ZP2A-Z31-1P
ZP2-TB20ZJS□-A10	ZP2-B20ZJS□	ZP2A-Z31-2P
ZP2-TB30ZJS□-A16	ZP2-B30ZJS□	ZP2A-Z31-3P
ZP2-T40ZJS-A20	ZP2-40ZJS	ZP2A-Z31-4P
ZP2-T46ZJS-A30	ZP2-46ZJS	ZP2A-Z31-5P

Ref. de repuestos (Modelo de conexión instantánea)

Ref. producto	Ref. de unidad de ventosa	Ref. del adaptador
ZP2-TB15ZJS□-AL12-06	ZP2-B15ZJS□	ZP2A-Z32-1
ZP2-TB20ZJS□-AL12-06	ZP2-B20ZJS□	ZP2A-Z32-2
ZP2-TB30ZJS□-AL14-06	ZP2-B30ZJS□	ZP2A-Z32-3
ZP2-T40ZJS-AL14-06	ZP2-40ZJS	ZP2A-Z32-4
ZP2-T46ZJS-AL14-06	ZP2-46ZJS	ZP2A-Z32-5

Serie **ZP2**

Serie ZP2

Dimensiones

Entrada de vacío: Modelo de rosca corta

ZP2-TB15ZJS□-A10 [Peso: 9 g]

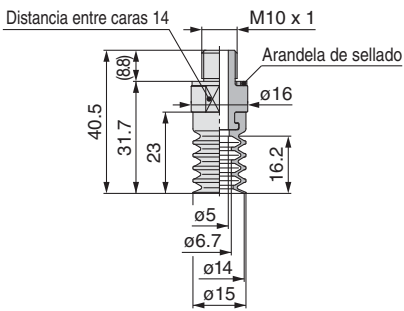

ZP2-TB20ZJS□-A10 [Peso: 9 g]

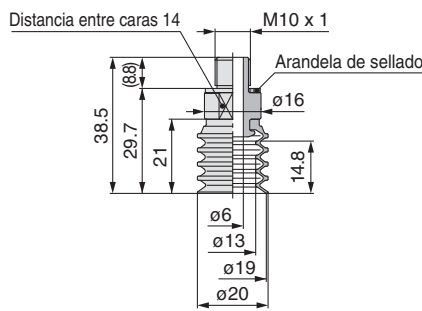

ZP2-TB30ZJS□-A16 [Peso: 20.5 g]

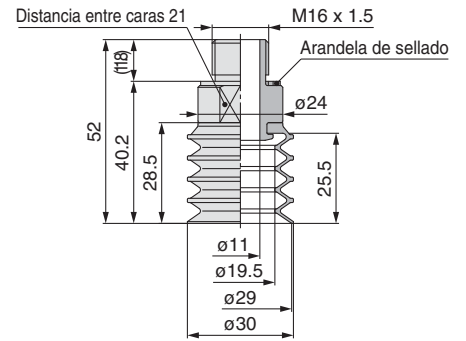

ZP2-T40ZJS-A20 [Peso: 50 g]

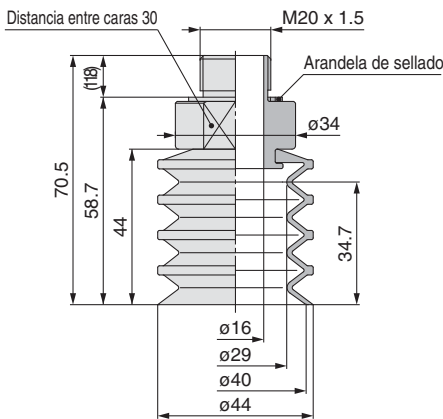

ZP2-T46ZJS-A30 [Peso: 82 g]

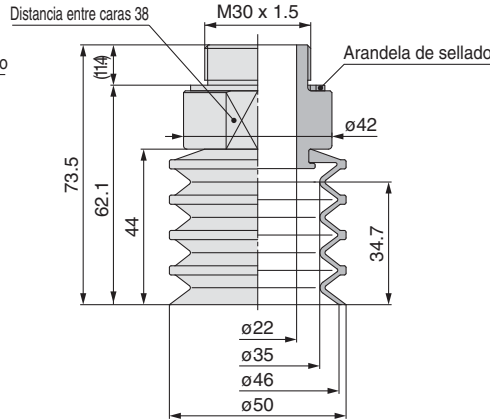

Entrada de vacío: Modelo de conexión instantánea

ZP2-TB15ZJS□-AL12-06 [Peso: 17 g]

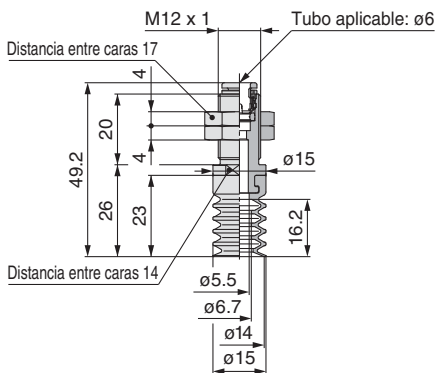

ZP2-TB20ZJS□-AL12-06 [Peso: 17 g]

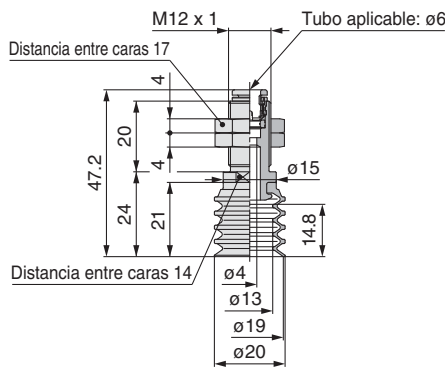

ZP2-TB30ZJS□-AL14-06 [Peso: 26.5 g]

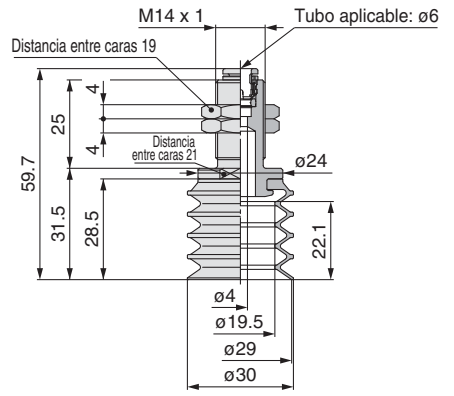

ZP2-T40ZJS-AL14-06 [Peso: 45 g]

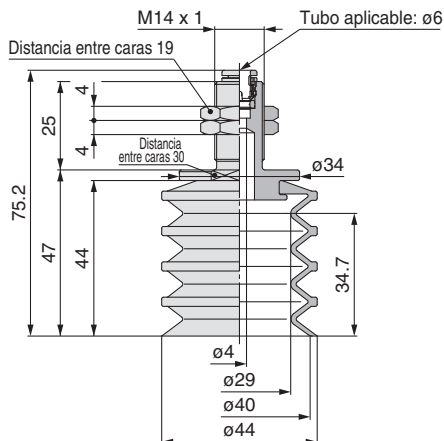

ZP2-T46ZJS-AL14-06 [Peso: 54 g]

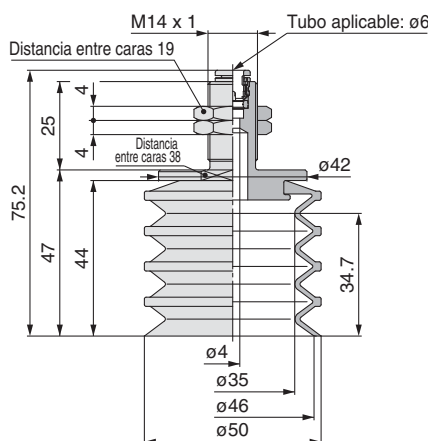

Forma de pedido

Unidad de ventosa **ZP2 - B15 ZJ S**



Diámetro de ventosa

Símbolo	Diámetro de ventosa
B15	ø15
B20	ø20
B30	ø30
40	ø40
46	ø46

Material de ventosa

Símbolo	Material	Diámetro de ventosa				
		ø15	ø20	ø30	ø40	ø46
S	Goma de silicona	●	●	●	●	●
		A40			A50	
S6	Goma de silicona Modelo de alta dureza	●	●	●	—	—
		A60			—	—

Dimensiones: Unidad de ventosa

ZP2-B15ZJS [Peso: 2.0 g]

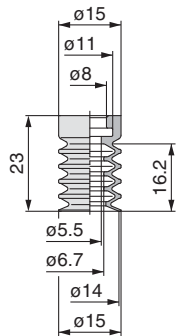

ZP2-B20ZJS [Peso: 2.0 g]

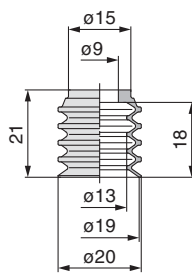

ZP2-B30ZJS [Peso: 4.5 g]

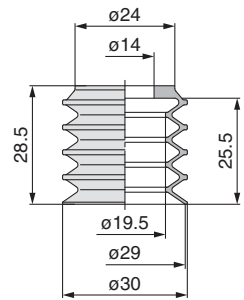

ZP2-40ZJS [Peso: 15 g]

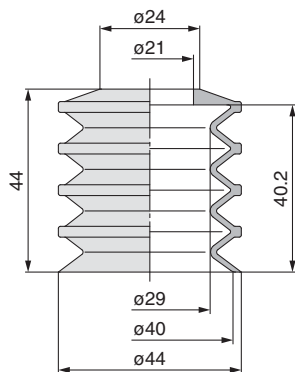

ZP2-46ZJS [Peso: 17 g]

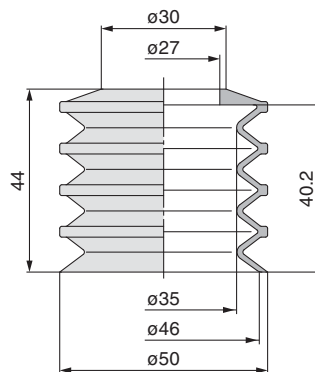

Dimensiones de montaje del adaptador

Si el cliente va a fabricar un adaptador, deberá diseñarlo con las siguientes dimensiones.

Ventosa aplicable **ZP2-B15ZJS**

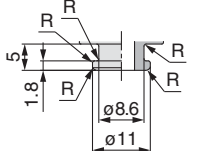

Ventosa aplicable **ZP2-B20ZJS**

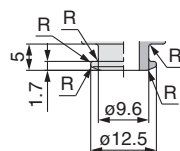

Ventosa aplicable **ZP2-B30ZJS**

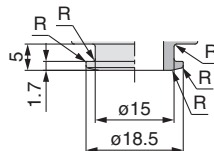

Ventosa aplicable **ZP2-40ZJS**

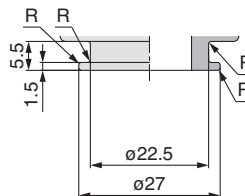

Ventosa aplicable **ZP2-46ZJS**

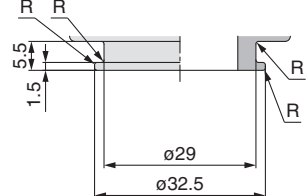

Nota) La pieza R debe ser lisa y sin bordes.

Serie ZP2

Lista de componentes

■ Modelo de rosca corta (ventosa con adaptador)

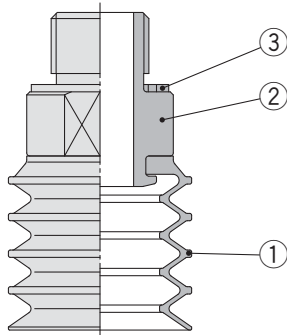

Lista de componentes

Nº	Descripción	Material (tratamiento de superficie)
1	Ventosa	Goma de silicona
2	Adaptador	Aleación de aluminio (anodizado)
3	Arandela de sellado	Acero estructural/NBR

■ Modelo de conexión instantánea (ventosa con adaptador)

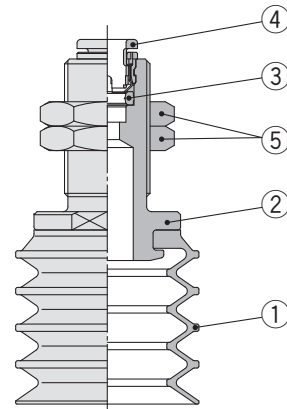

Lista de componentes

Nº	Descripción	Material (tratamiento de superficie)
1	Ventosa	Goma de silicona
2	Adaptador	Aleación de aluminio (anodizado)
3	Junta	NBR
4	Casete	—
5	Tuerca	Acero estructural (cromado trivalente)

Modelo de rosca corta

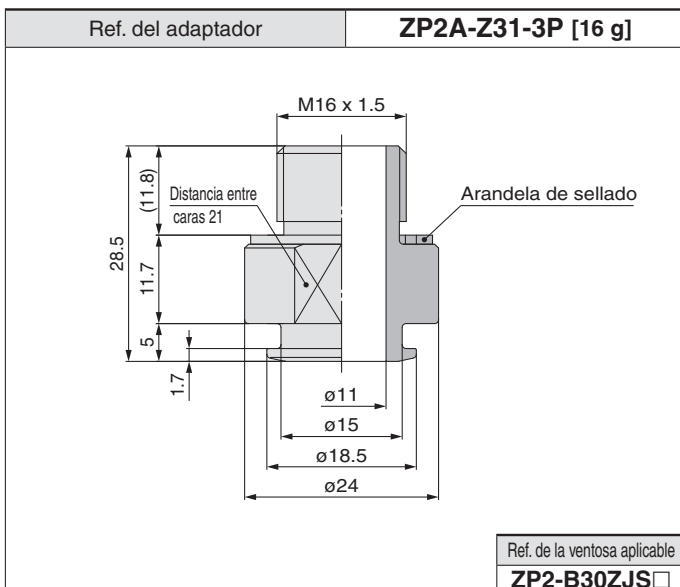
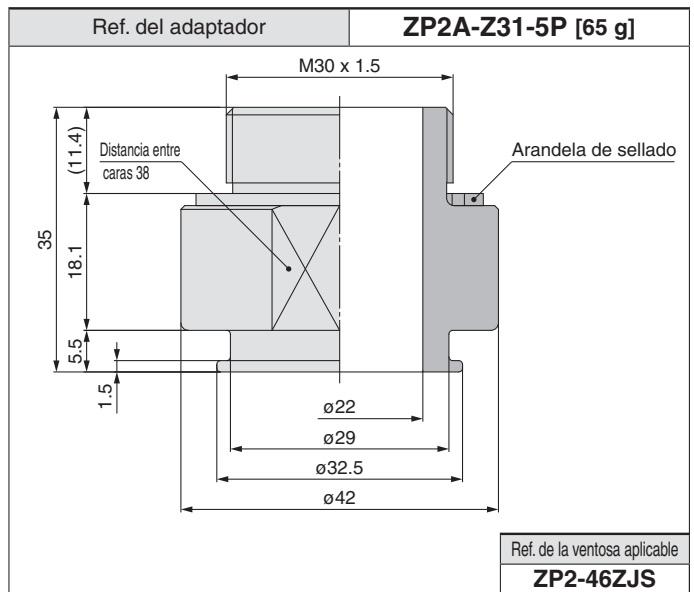
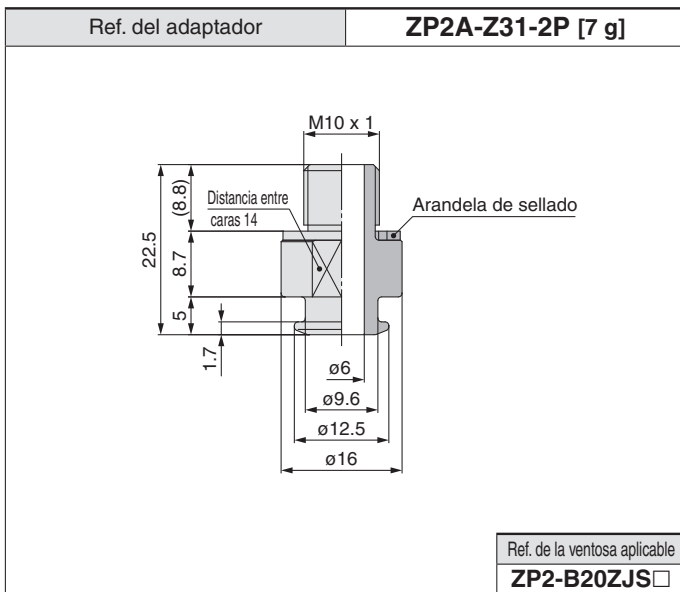
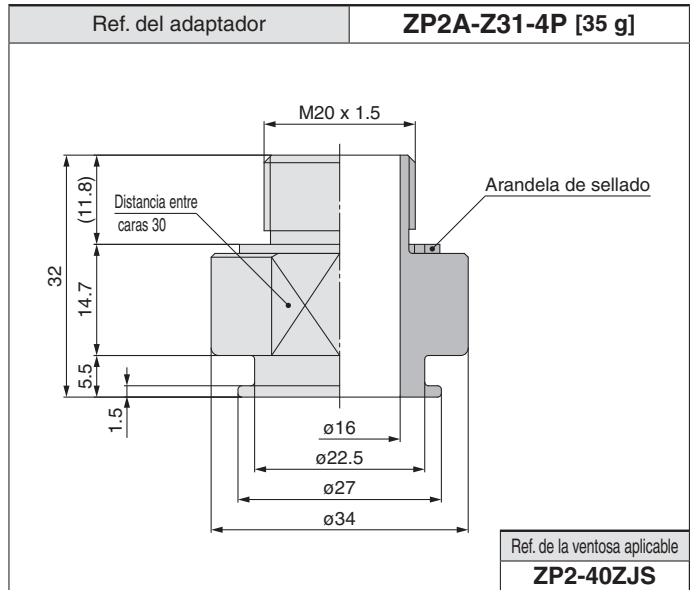
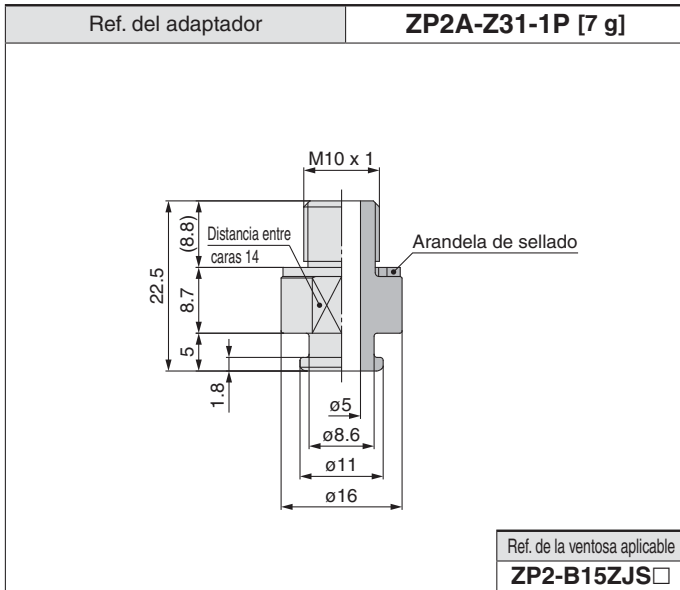

Modelo de conexión instantánea

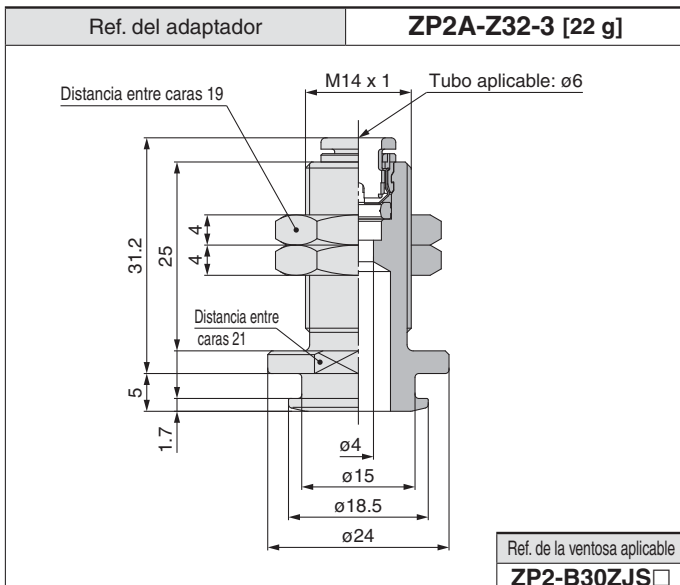
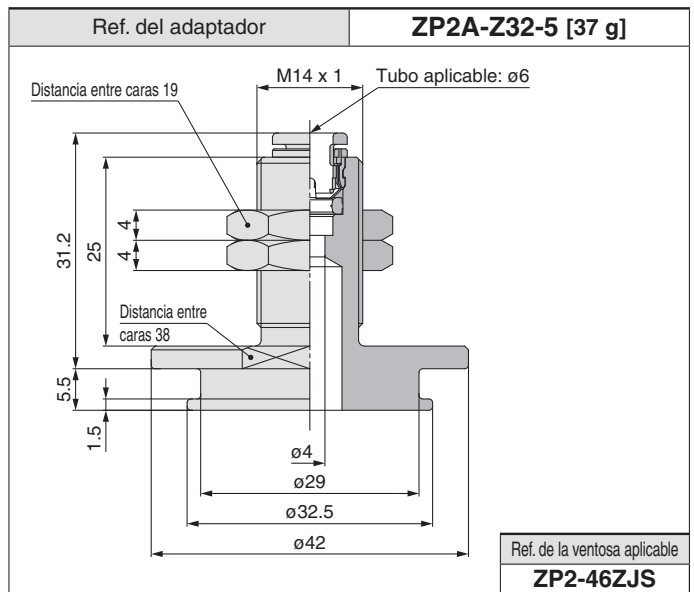
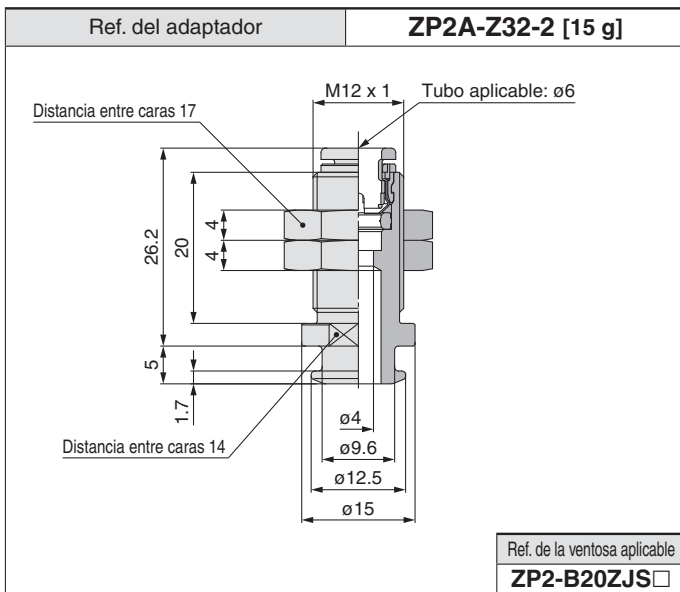
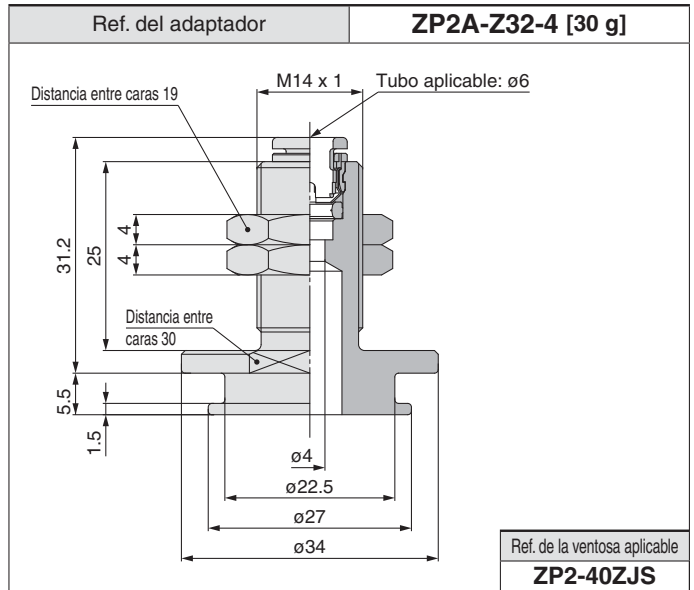
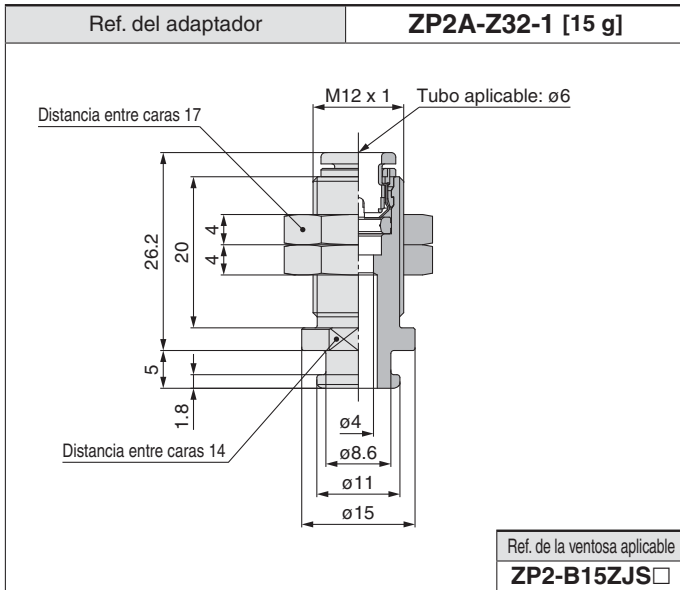

Desplazamiento de la ventosa a presión de vacío

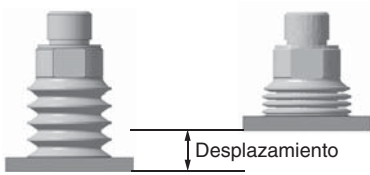

Los datos mostrados abajo no están garantizados, sino que son medidas aproximadas (valor inicial). Dichos valores dependen del entorno de trabajo, el peso de la pieza y el método de traslado, por lo que SMC no puede garantizarlos. Antes de usarlos, es necesario llevar a cabo pruebas y confirmaciones.

ZP2-B15ZJS

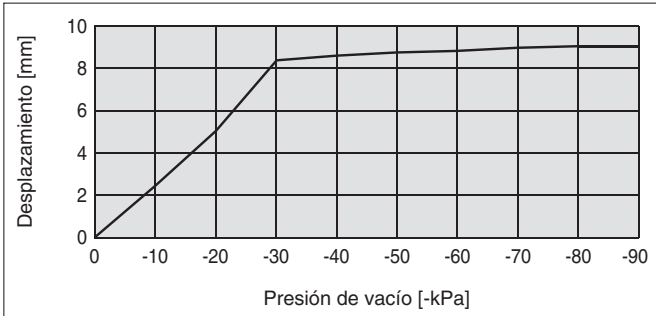

ZP2-B15ZJS6

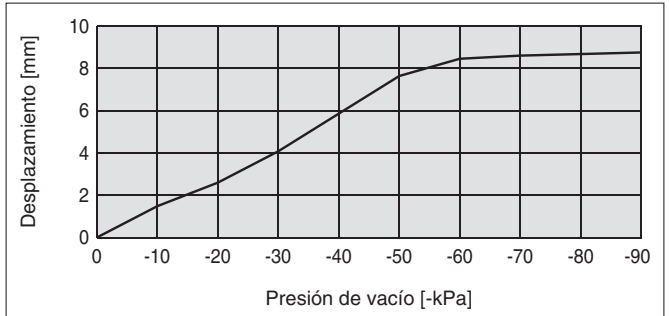

ZP2-B20ZJS

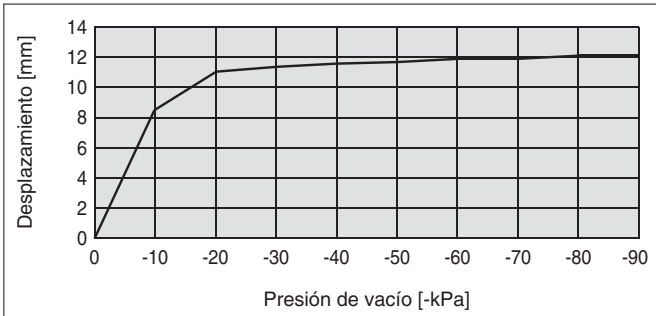

ZP2-B20ZJS6

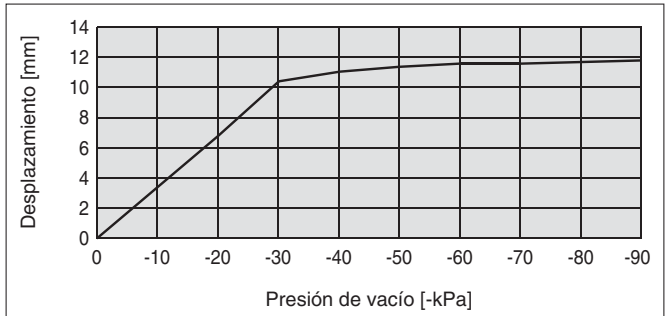

ZP2-B30ZJS

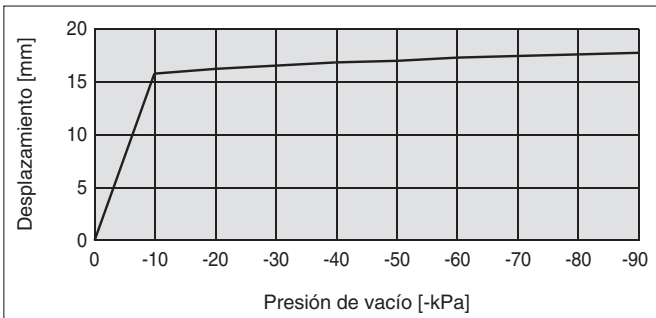

ZP2-B30ZJS6

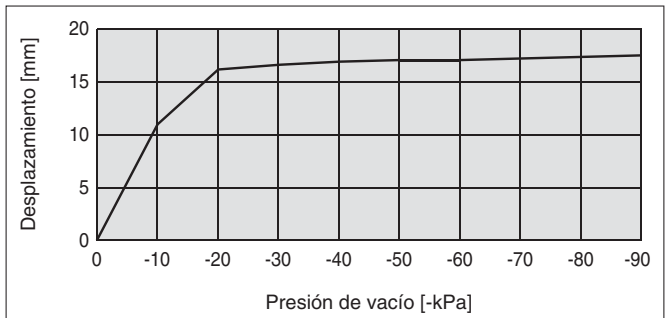

ZP2-40ZJS

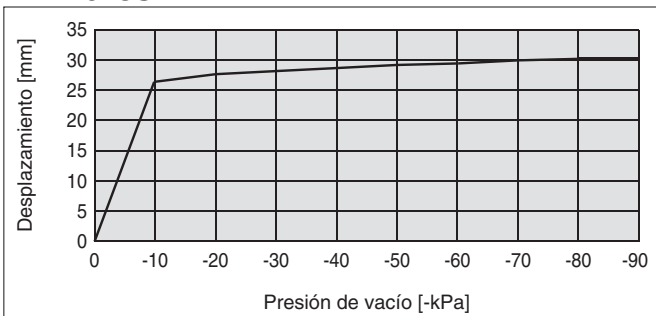

ZP2-46ZJS

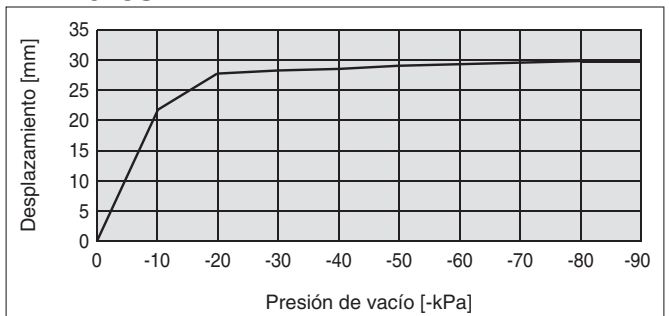



SMC Corporation (Europe)

Austria	☎ +43 (0)2262622800	www.smc.at	office@smc.at
Belgium	☎ +32 (0)33551464	www.smc-pneumatics.be	info@smc-pneumatics.be
Bulgaria	☎ +359 (0)2807670	www.smc.bg	office@smc.bg
Croatia	☎ +385 (0)13707288	www.smc.hr	office@smc.hr
Czech Republic	☎ +420 541424611	www.smc.cz	office@smc.cz
Denmark	☎ +45 70252900	www.smc.dk.com	smc@smc.dk.com
Estonia	☎ +372 6510370	www.smc-pneumatics.ee	smc@smc-pneumatics.ee
Finland	☎ +358 207513513	www.smc.fi	smc.fi@smc.fi
France	☎ +33 (0)164761000	www.smc-france.fr	promotion@smc-france.fr
Germany	☎ +49 (0)61034020	www.smc.de	info@smc.de
Greece	☎ +30 210 2717265	www.smc-hellas.gr	sales@smc-hellas.gr
Hungary	☎ +36 23511390	www.smc.hu	office@smc.hu
Ireland	☎ +353 (0)14039000	www.smc-pneumatics.ie	sales@smc-pneumatics.ie
Italy	☎ +39 0292711	www.smc-italia.it	mailbox@smc-italia.it
Latvia	☎ +371 67817700	www.smc.lv	info@smc.lv

Lithuania	☎ +370 5 2308118	www.smc.lt	info@smc.lt
Netherlands	☎ +31 (0)205318888	www.smc-pneumatics.nl	info@smc-pneumatics.nl
Norway	☎ +47 67129020	www.smc-norge.no	post@smc-norge.no
Poland	☎ +48 (0)222119616	www.smc.pl	office@smc.pl
Portugal	☎ +351 226166570	www.smc.eu	postpt@smc-smces.es
Romania	☎ +40 213205111	www.smc-romania.ro	smcromania@smcromania.ro
Russia	☎ +7 8127185445	www.smc-pneumatik.ru	info@smc-pneumatik.ru
Slovakia	☎ +421 (0)413213212	www.smc.sk	office@smc.sk
Slovenia	☎ +386 (0)73885412	www.smc.si	office@smc.si
Spain	☎ +34 902184100	www.smc.eu	post@smc-smces.es
Sweden	☎ +46 (0)86031200	www.smc.nu	post@smc.nu
Switzerland	☎ +41 (0)523963131	www.smc.ch	info@smc.ch
Turkey	☎ +90 212 489 0 440	www.smc-pneumatik.com.tr	info@smc-pneumatik.com.tr
UK	☎ +44 (0)845 121 5122	www.smc-pneumatics.co.uk	sales@smc-pneumatics.co.uk